

**PR801LTE IP66 Waterproof Wireless
Wildlife Camera 4G 60MP 8K Hunting
Trail Camera**





1. Antenna port
2. 2.0" Display
3. SIM card
4. Lock Hole
5. Lock Hole
6. Menu
7. UP (Record mode)
8. Shot
9. Enter
10. Left
11. Right
12. Mode
13. Down
14. Replay
15. loud speakers
16. TF Card
17. USB
18. Power switch
19. Battery box

Main Menu

- Cellular: ON/Off
- Cellular Info: As Described
- Bind App: Necessary to Activate the Sim Card
- Mode: Motion Detection/Time lapse normal
- Work Time: Customer Setting
- Photo or Video: Single
- Photo Resolution: 2MP-60MP
- Video Resolution: 720P-8K
- Photo Burst: 1/2/3P
- Video Length: 5 to 30 seconds
- Audio Recording: On/Off
- Detection Delay: 5 seconds to 1 hour
- PIR Sensitivity: Low/Middle/High
- Motion Test: PIR Trigger
- Fill light Distance: Near/Middle/Far
- Camera Name: Yes
- Date & Time: Mon/Day/Year/Hour/Min/Sec
- Date Format: D/Y or others
- Time Format: 12h/24h
- Loop Record: On/Off
- Beep Sound: On/Off
- Memory Card Format: No/Yes
- Language: English/Deutsch/Français/Español/Nederlands/Italiano/Polish/RUS
- Password Protection: set on Camera
- Factory Rest: No/Yes
- Version Info: As Described

Power Switch:

- OFF - Power off
- SETUP - The screen lights up, set menu, parameters, mode, etc.
- ON - Wait 5 seconds, after the screen goes off, the camera enters infrared sensor mode

How to use it?

Step 1: Preparation

1. Unlock both side locks to access and turn on the camera.
2. Open the battery cover and carefully install the 8X1.5V AA alkaline batteries.
3. Insert a Micro TF memory card (preferably 32GB) into the designated slot on the bottom of the device.
4. Insert the SIM card, especially the one included in the package, into the slot located on the left side of the camera.



Battery (4 or 8 cells)



TF card



SIMcard (Bundled)

Step 2: Bind App and Select Plan

1. Scan QR code to download "Trail Cam Go"app.



Android QR Code



TrailCam Go



iOS QR Code

- After installing the App, please sign up for your account using your frequently used email address.

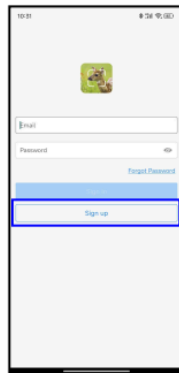
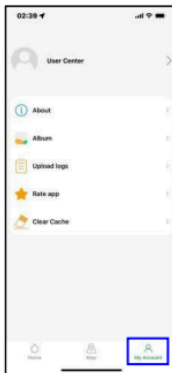

Select Region



Enter Email

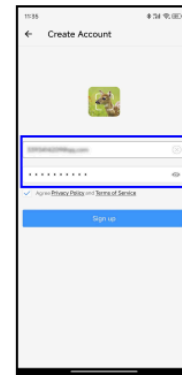
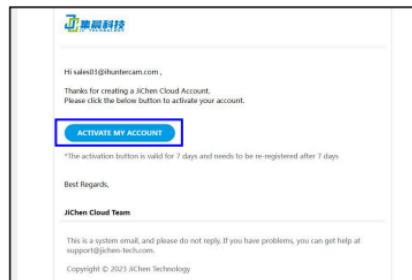

Login by entering your registered email address

- To Add a Camera, first navigate to the main interface of the APP. Tap the "+" icon positioned centrally on the screen, and from the options that appear, select "4G Camera". Subsequently, click on "Direct Add" (disregarding the option to Set APN). Ensure you have thoroughly read and confirmed that you are adhering to the provided "Setup Guide".

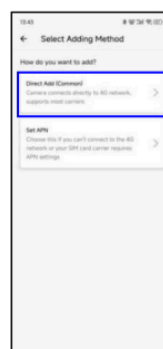
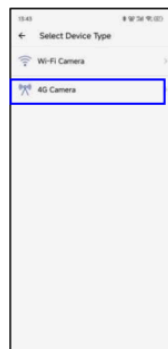
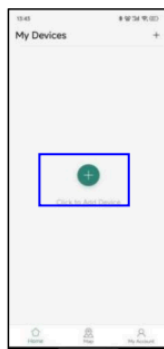

- The phone screen will prominently display a QR code. Pick up your Trail Camera, switch the button to SET UP, click MENU and select "Bind APP" to scan the QR code displayed on your phone. Once you hear the beep, it signifies that the camera and phone are connecting, which typically takes a few seconds. During this process, please refrain from making any changes to either your phone or camera settings. Once binding is successfully completed, you may proceed to name the camera and make any necessary adjustments to its settings.



- Click on "Plans" within the app to activate your SIM card and select the option that best suits your needs. You have the flexibility to pay using either "PayPal" or credit cards.

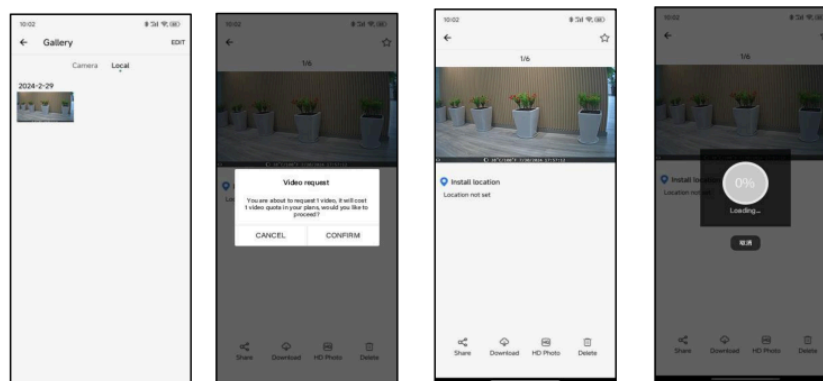

6. To set up your trail camera, click on "Settings" within the app. Once configured, it will automatically synchronize with your trail camera.

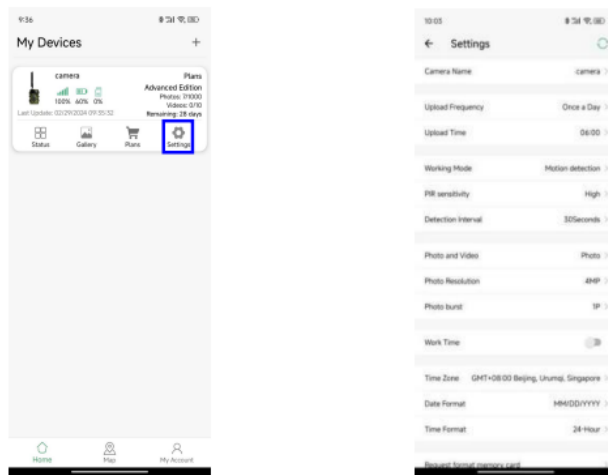

7. Tap on "Gallery" to view photos and videos captured by the camera. Depending on your subscription plan, you may choose to download high-resolution images. Additionally, you have the option to save these media files to your local album for future access.

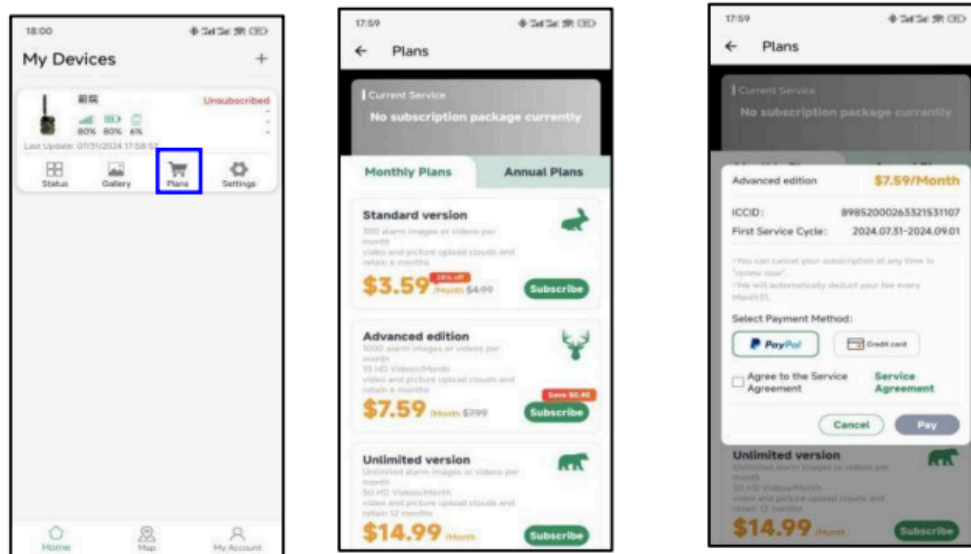

8. You can inspect the camera's status, encompassing signal strength, battery life, memory card capacity, and version information.

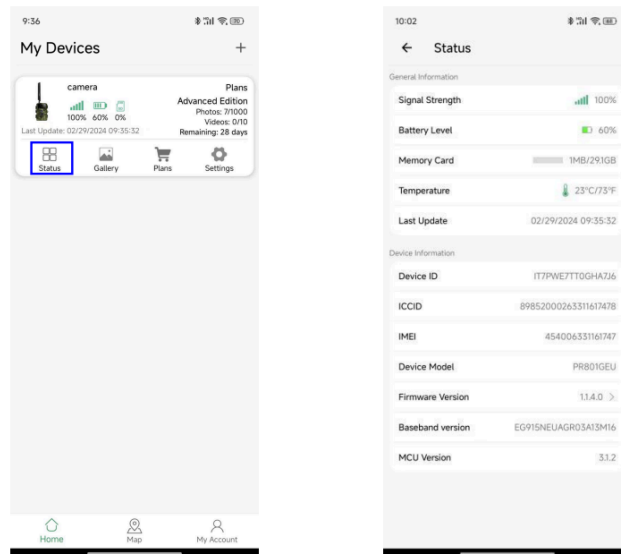

Step 3: Setting on Camera

1. Switch “OFF” to “SETUP”

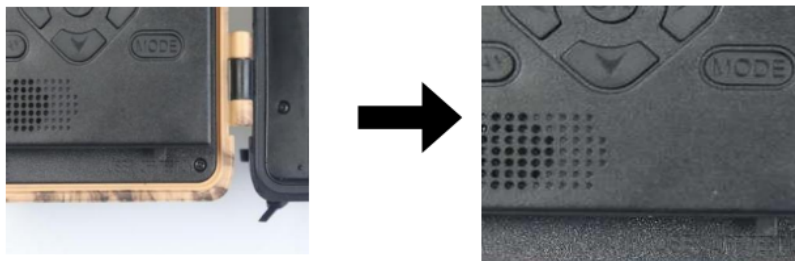

2. Format SD card (MENU→Memory Card Format→OK→YES)

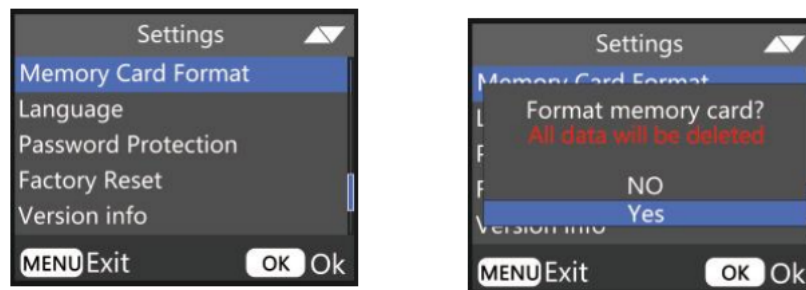

3. Reset camera (MENU→Factory Reset→OK→YES)

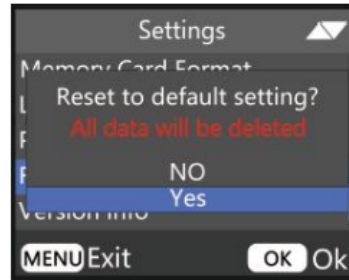
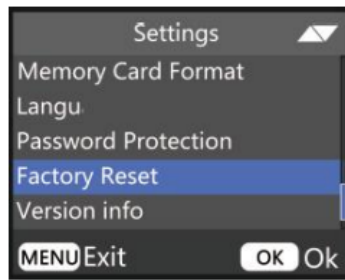

Press the "MENU" key to enter the menu (OK key to confirm, MENU key to return).
After the setting is completed, please confirm that the button is turned to "ON".

Cellular: ON/OFF

- Set it on to allow sending photos and video from Camera to App

Cellular Info: Viewing the cellular information

Bind APP: Scan the QR code on TrailCam Go App

Mode: Motion Detection

- By selecting this mode, the camera will only record when it senses motion, if no motion is detected, the camera will enter standby mode.
- For example, setting the Detection Delay to 30s means that the camera will turn on the motion detection mode every 30s. You can set the time interval from 5 seconds to 1 hour.

Time-lapse normal

- By selecting this mode, the camera will shoot directly even if the picture does not move, similar to the video recording function of a cell phone. Each video will be saved separately.
- For example, if the capture interval is set to 5 minutes and the video length is set to 15 seconds, the camera will capture 15 seconds of video every 5 minutes.

Work Time: Off, ON

When turned ON, you can customize the camera's working time. For example, set to 22:00-07:00 when the switch is moved to the "ON" position, the camera will start working at 22:00 and end at 07:00.

Photo or Video: Photo, Video, Photo & Video

Select the file mode captured by the camera:

- Photo resolution: 2M,4M,8M,16M,20M,24M,32M, 36M, 42M, 48M, 60M
- Video resolution: 720P, 1080P,2.7K, 4K, 8K
- Photo Burst: 1P, 2P, 3P

Set the number of images taken by the camera.

- Video Length: 10 sec

Default 10s, you can set 5S-30S, press up and down key to switch.

Audio Recording: ON, OFF

Choose whether to record video sound when the camera is working.

Detection Delay: 30s

Default 30s, you can set 5s-1 hour, up and down keys to switch. This function is to set the recording interval for motion detection. After the first sensing, you need to wait 30 seconds to start the next motion sensing. You can also set it in Mode-Motion Detection.

PIR Sensitivity: Low, Middle, High

You can set the sensitivity according to the shooting distance. Low: short sensing distance (3-4meters), Medium: moderate sensing distance (7-8 meters), High: long sensing distance (12-15meters)

Motion Test

- a. This function is used to test if the PIR function is normal.
- b. For example, if you move in front of the lens, if the PIR trigger number increases, the function is normal. If the movement is obvious, but the PIR trigger number does not change, you need to adjust the PIR Sensitivity.

Fill Light Distance: Near, Middle, Far

- a. This function is used for the fill light effect when the camera is working at night. Adjusting the distance of the fill light can improve the reflection situation when shooting at night.
- b. Low: close distance (3-4 meters), Medium: moderate distance (7-8 meters), High far distance (12-15meters).

Camera Name: ON, OFF

Select "ON", you can set a number or letter as the name of the camera, which will be displayed at the bottom right of the photos or videos you take.

Date & Time: Setting the camera's time

Since the camera does not have WIFI capability, the time needs to be set manually.

Date Format: D/M/Y, MD/Y, Y/M/D

You can set the camera's date format according to your habits

Time Format: 24H/12H24H/12H**Loop Record: ON, OFF**

Select "ON", when the SD card is full, the new file will overwrite the previous one. Select "OFF", the camera will stop recording when the SD card is full.

Beep Sound: ON, OFF**Memory Card Format**

Select Format and all files on the SD card will be deleted.

Language

English/Deutsch/Français/Español/Nederlands/Italiano/Polish/Russian

Password Protection: Off, ON

You can set a 4-digit camera password. If you forget your password, please follow the steps below: press and hold the " ^ " key + "OK" key at the same time, and then turn the switch to the SETUP position.

Factory Reset: Select 'Yes' to restore the camera to its factory settings.

Version Info: Viewing the camera's version.

Press "REPLAY" key to enter the REPLAY (REPLAY key to return)

1. Up and down keys to switch pictures or videos, OK key to play and pause the video
2. "MENU" key to choose to delete the current file or all files. Press "MENU" again to cancel "MENU"

Power cord functions

1. USB Cable, used to connect the camera to a computer to view information on SD card files, no charging capability.
2. DC 6V Cable, it is possible to power the camera without a battery, and since the camera does not have a built-in battery, the camera will turn off after unplugging the 6V cable.

Sensing Angle and Distance Test

1. (MENU) Toggle the power switch to TEST.
2. Make movements in front of the camera at several positions within the area where you expect the object will be. Try different distances.
3. If the red indicator LED light blinks, it indicates that position can be sensed. If it does not blink, that position is outside of the sensing area. The results of your testing will help you find the best placement when mounting the camera.

Mounting Camera

1. When setting up the camera for scouting games or other outdoor applications, you must be sure to mount it in place correctly and securely. We recommend mounting the camera on a relatively straight tree with a diameter of more than 15cm (6 in.), make sure the tree is large enough to not sway in the wind as this can cause a false trigger. Position your camera facing north or south. If you position your camera aiming east or west your camera tends to have a greater frequency of false triggers due to the rising or setting sun passing through the frame.
2. To get the optimal photo quality, the tree should be about 5 meters (16-17 ft.) away from the place to be monitored, with the camera placed at a height of 0.75 -1m (2.5 -3.5ft.). Attaching your camera too low can result in getting too many pictures of small non-targeted creatures. Placing your camera too high and facing downward can cause the camera to pick up shadows and the changes in ground temperature.

3. Also, keep in mind that you will get the best results at night when the subject is within the ideal range, no farther than 30m(98ft.); and no closer than 3m(10ft.) from the camera.
4. To enhance the flash, we recommend positioning the camera in an area with a backdrop to reflect the maximum amount of light.
5. Clear all vegetation from in front of the camera. Any small limbs, twigs, leaves, or grass blowing in the wind can trigger a false image.
6. Test the camera. After following the steps above to ensure it is not something environmentally driven or a result of the settings, please follow step:
 - Take your camera and place it facing a blank wall on a sturdy surface.

Troubleshooting

No photos are being sent to my APP?

- Please ensure that you are utilizing the SIM card that was included in the package.
- Confirm that the card has been activated and prepaid, and that there is a signal present on both your camera and phone.

Can not record a photo or video or not capture a subject of interest?

- Low battery. Please install eight fresh alkaline batteries, ensuring no mixing of old batteries or batteries from other brands.
- No or Wrong SD card, format the SD card first via the camera.
- Wrong settings of Work Time: If the Work Time is set, the camera will only work during this time, and it will be in standby at other times.
- Try to avoid setting the camera up on small trees that are prone to being moved by strong winds.
- Remove any limbs which are right in front of the camera lens.
- Do not install the camera behind the window glass.

Is the picture too dark or over exposed at night?

- The illumination parameter is not set correctly, set Fill light Distance to far.
- Lack of reflective background at night: we recommend positioning the camera in an area with a backdrop to.
- Reflect the maximum amount of light. For instance, place the camera 8-12m(20-30ft.) from fieldedge facing the woods.
- Low batteries power

Battery life is shorter than expected?

- Battery quality and cold temperature will affect the battery lifetime.
- Too many unwanted false triggers like branches or weeds blown by the wind, set PIR Sensitivity to low.

No photos were taken in Motion Detection?

- Remove all the protective film on the camera Lens, and keep a distance of 30 meters (98 ft).
- Click on the menu, select "Mode" - "Motion Detection", choose the detection delay time and set it for a few seconds. Then traces of animal movement will be recognized within a few seconds. Then click "OK".
- Select "work Time", then select "Open", then set the time you want the camera to start working.
- Select "PIR sensitivity", the higher the sensitivity, the more sensitive and faster the recognition, and at the same time, the more power consumption.
- Select "Detection Delay" to set the frequency of taking photos. Take photos every few seconds or hours.
- In "Motion Test", move your hand or a person or an animal to see if any motion is detected, if so, you can start taking photos.

When I turn on the camera, the screen just continually flashes white?

- It may be due to poor battery contact. It is recommended to remove the batteries, wipe both ends of the battery and the positive electrode by a clean cloth.

What if I forget my camera password?

- Turn off the camera, then press OK and UP keys hold while adjusting the power switch to SET mode to unlock it.

Why is there air in the trail camera? Is it a leak?

- The air inside the camera is currently at a normal humidity level. Temperature fluctuations can sometimes cause condensation, which will dissipate once the temperature stabilizes. Alternatively, you can accelerate the removal of condensation by using a desiccant.