

# User Manual for Portable Full HD LED Mini Projector GP80

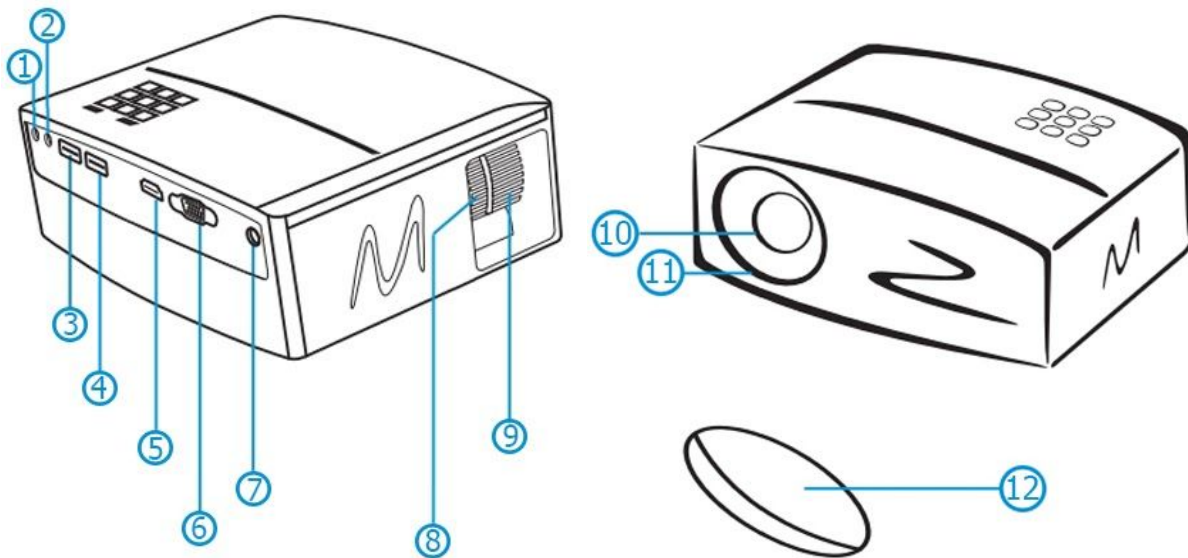

## Specifications

- Model: GP80
- LED highlights: 42W, 18K color temperature up to 50k Hrs life
- Physical resolution: 1280 x 720 pixels
- Brightness: up to 3500 LED lumens
- Image size: 50-120" (150~350cm)
- Aspect ratio: 16:9/4:3
- Contrast ratio with dynamic: 10,000:1
- Display color: 1.07 Billion Colors
- Lens: F=125mm
- Resolution support: VGA to 4K (3840 x 2160)
- With the integrated media player
- Stereo speaker: 1x5Watt
- Ports: 2xUSB, HDMI, AV
- Power source: AC 100~240V 50/60Hz
- Dimensions: 200 x 158 x 80mm
- Weight: 0.99kg



1. Audio OUT
2. AV (RCA)
3. USB In 1
4. USB In 2
5. HDMI
6. VGA

7. DC In
8. Keystone correction
9. Focus
10. Focus
11. Lens
12. Lens cover

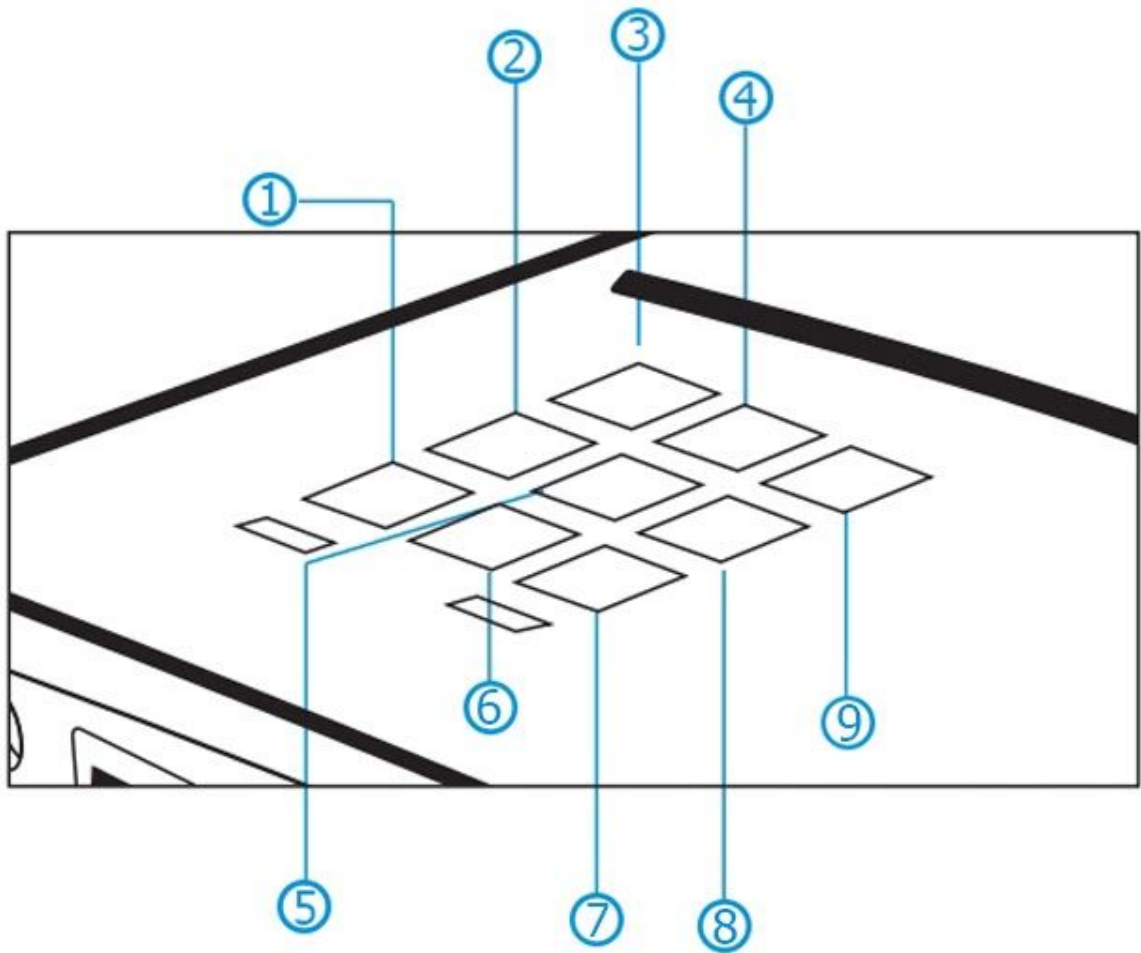

1. Source
2. Volume down
3. Menu
4. Up
5. Enter/OK
6. Down
7. Return
8. Volume up
9. On/Off

### **How to use**

1. Turn on the projector by pressing the power button on the remote or on the projector. If you connect it using the USB connection, you'll get the screen where you can choose the mode.
2. Press the Source button or press Input on the remote, and select the desired input source.
3. Place the projector on a stable surface and focus the image. Turn the focus knob until the image is clear.
4. Adjust the volume using the buttons on the projector or the remote