

USER MANUAL for VR Shinecon Virtual Reality 3D Glasses

Product accessories

- VR Shinecon Virtual Reality 3D Glasses
- Bluetooth Remote Shutter / Control

Pictures and Buttons



1. Adsorption type switch
2. Object distance adjusting knob
3. Removable front cover
4. Focal distance adjusting knob
5. Optical glasses
6. Focus adjustment knob
7. Comfortable cushion

Technical data

- Adjustable focal distance (up to 20mm)
- Adjustable object distance (up to 5mm)
- For smartphones up to 170mm long
- Supported OS: iOS and Android
- Openings for headphones and charging port
- The remote can be used as a joystick, a wireless mouse and a selfie shutter

How to use the VR Glasses

First of all you need to download the VR App from the Google Play Store or Apple Store on your device. Test if it supports Left-and-Right split screen and full-screen display. Then open the front of the glasses as shown on the picture below.

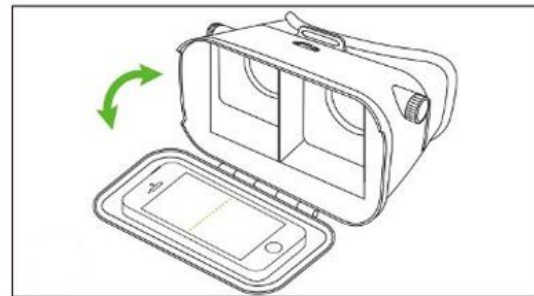
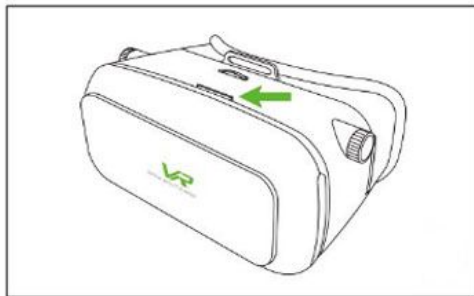
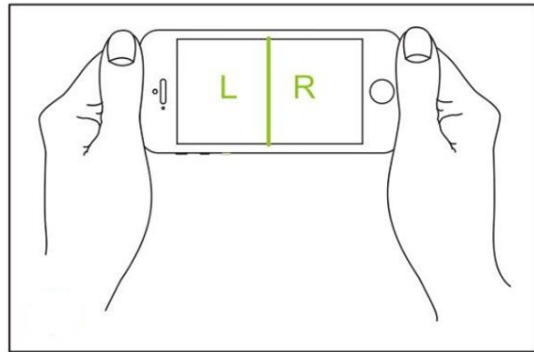
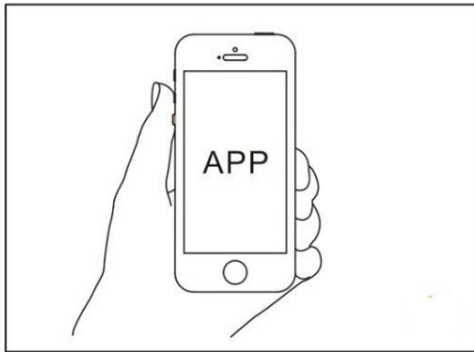

Hold your device facing inward and place it on the cover and close it.

***Note:** If the picture is upside down, turn your handset around.

Adjust the object distance to watch videos without glasses or lens (if you wear it). Focal adjustment for the best clarity of the picture.

You can choose the video by shaking your head from left to right in the video list. 3D games are also controlled the same way, as shown in the picture below.

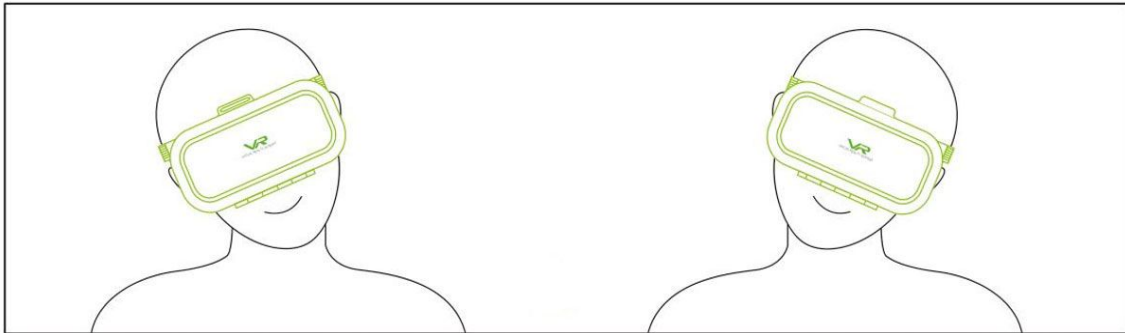

Compatibility

The Shinecon Virtual Reality 3D Glasses are compatible with smartphones that has a display size between 4" and 6" and that are up to 170mm long.

The glasses are specially designed to adapt to the needs of short-sighted people. Also, it fits to all head sizes thanks to the flexible velcro straps.