

# User Manual for TWS M7S Earphones with LED Charging Case

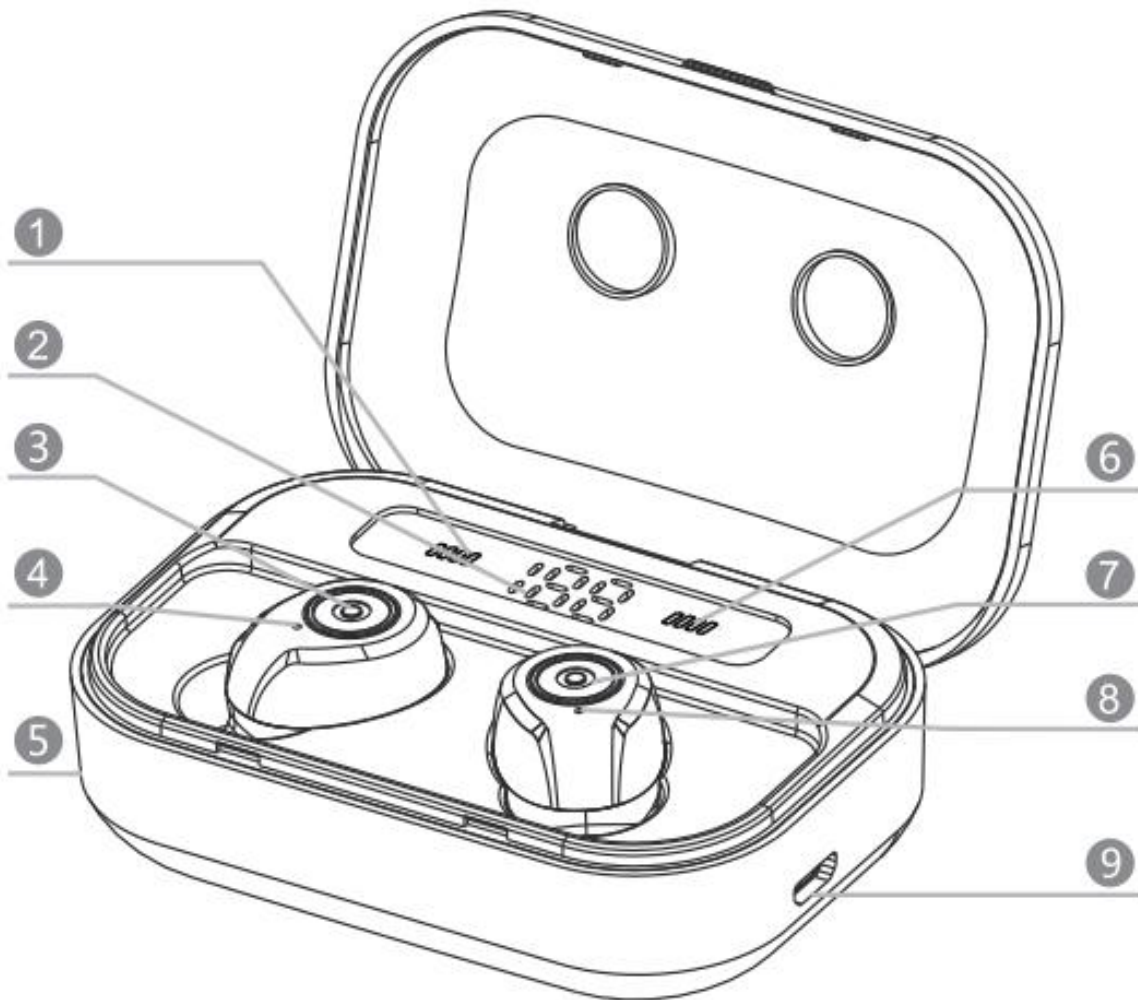

## Specifications

- Bluetooth version: 5.0
- Headphone battery capacity: 50mAh (per headphone)
- Headphone charging time: 45min
- Case battery capacity: 1500mAh
- Case charging time: 6 hours
- Call time: 6h
- Music time: 4h
- Driver diameter: 8mm
- Water resistance rating: IPX7



1. Charging case indicator
2. Charging status display
3. Touchscreen
4. Earbud tip light
5. USB output port

6. Charging status display
7. Touchscreen
8. Earbud tip light
9. MicroUSB input port

## Before the first use

Select the earcaps that fit your ear, put them on the earbuds, and put them back into the charging case. It's recommended that you charge the earbuds and charging case before the first use, or if you haven't used it for a long time.

## Charging the earphones and the case

When charging the case use the charging cable and connect it to the PC or your charging adapter. You can also charge the charging case wirelessly using your wireless charger.

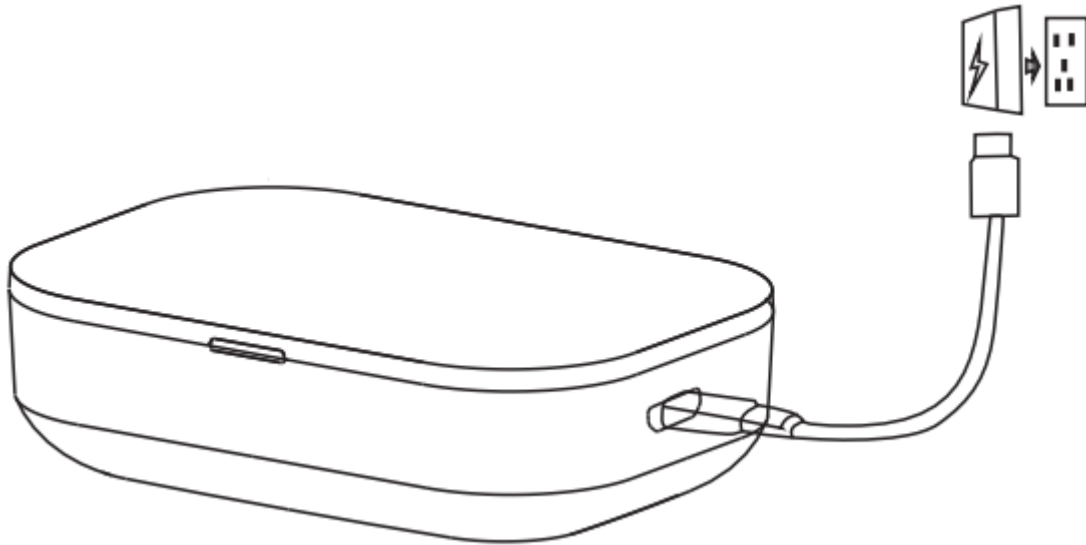

While charging the digital display will be flashing. Once the charging case is fully charged the display will show 100 which means that you should disconnect it from the power supply.

Please note that you should use 5V and 1A power adapter to charge the charging case or use the USB port on your PC/Laptop.

When charging the earbuds place them in the charging case and close the lid. Make sure that the charging case is fully charged before starting. While charging, both the left and the right indicator will flash with red light. Once the earbuds are fully charged, all indicators will turn off and the charging case will automatically power off.

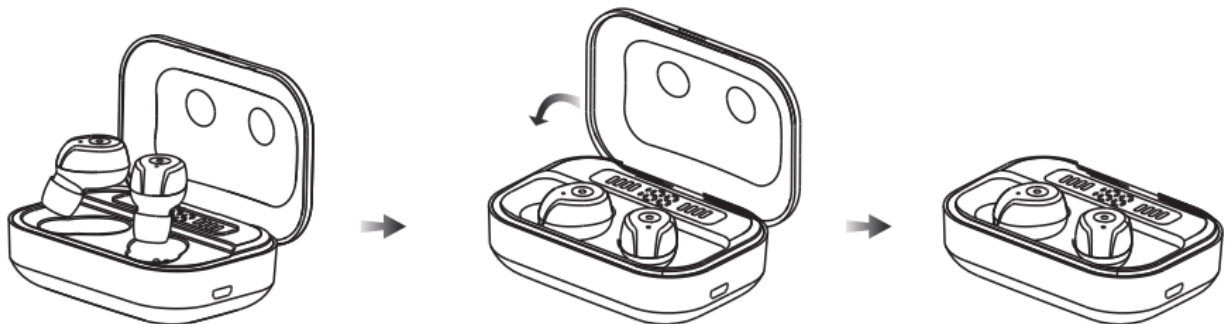

## **Earbud wearing and powering on/off**

For the best result and comfort please wear the earbuds correctly according to the symbols L and R on the back of the earbuds. Align the earpiece into the ear canal, rotate it back and forth to place it in the best comfortable angle.

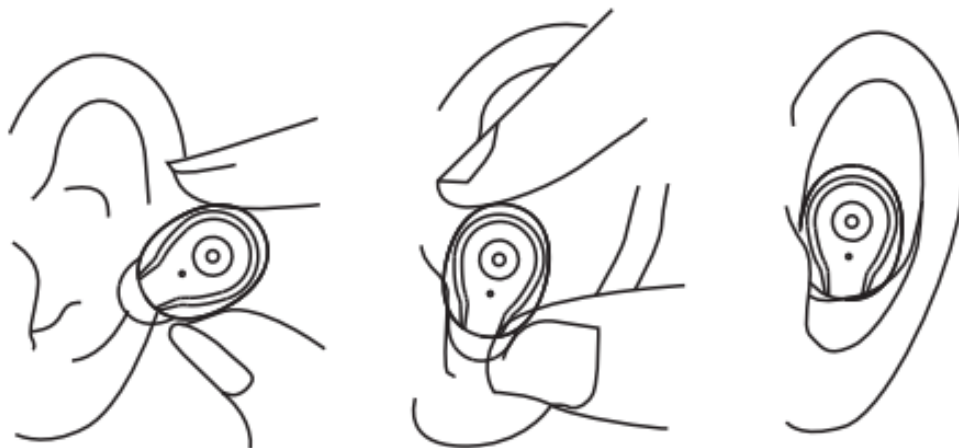

The earbuds will power on automatically once you take them out of the charging case. You can also power them on manually if the charging case is not around. To do so, press and hold the touchscreen of both earbuds for two seconds until the blue and red indicator lights alternately start flashing.

The earbuds will automatically power off once you put them back into the charging case. If you don't have the charging case around, you can disconnect your phone's Bluetooth and the earbuds will automatically turn off after 5 minutes. Also, you can turn them off manually by holding both touchscreens of the earbuds for 6 seconds. The red light will turn on as an indicator that the earbuds are powered down.

## **Pairing**

Take out the earbuds from the charging case. They will turn on and pair with each other automatically. To pair them with your phone, turn on the Bluetooth on your device and search for available devices, and tap on the TWS M7 to connect. When using the earbuds again, they will automatically pair with the latest used device after power on.

If they can't be paired automatically, please try the following steps:

1. Turn off the Bluetooth on your phone and turn off the earbuds and then press the touchscreen for 3 seconds until you see the red and blue light flashing.
2. Double-tap the touchscreen on one of the earbuds and wait for 3 seconds. The earbuds will pair with each other once you see one flashing red and blue and the other is not flashing at all.
3. Turn on the Bluetooth on your device and pair with the earbuds as described above.

## **Earbuds functions**

- **Voice assistant:** After connecting the earbuds, double-tap the touch area to wake up or turn off the assistant.
- **Incoming call/voice report:** If you have a missed call, you'll hear an alert tone on both earbuds.
- **Answer a call:** Touch any earbud once to answer a call.
- **Hang up:** During a call, touch any earbud once to end the call.
- **Cancel outcall:** While dialing, touch any earbud to cancel the outgoing call.
- **Reject a call:** Touch one of the earbuds during the incoming call to reject it.
- **Music playback:** While playing music, touch the left earbud twice to switch to the previous song and touch the right earbud twice to switch to the next song. Touch any of the earbuds once to play or pause music.
- **Volume adjustment:** While playing music, touch the right earbud three times to decrease the volume, and touch the left earbud three times to increase the volume.